

DEDICATION

KNOW ALL MEN BY THESE PRESENTS THAT FLA MANGO, INC., A FLORIDA CORPORATION, and COUNTRY DEVELOPMENT CORP., A FLORIDA CORPORATION, OWNERS OF THE LAND SHOWN HEREON, BEING A PORTION OF THE NORTH ONE-HALF OF THE NORTHEAST ONE-QUARTER OF THE SOUTHWEST ONE-QUARTER OF SECTION 25, TOWNSHIP 44 SOUTH, RANGE 42 EAST, PALM BEACH COUNTY, FLORIDA, SHOWN HEREON AS "THE COUNTRY" AND BEING MORE PARTICULARLY DESCRIBED AS FOLLOWS:

FROM THE CENTER OF SAID SECTION 25, TOWNSHIP 44 SOUTH, RANGE 42 EAST, PALM BEACH COUNTY, FLORIDA, BEAR SOUTH 00° 02' 34" EAST, ALONG THE EAST LINE OF THE SOUTHWEST ONE QUARTER OF SAID SECTION 25, ALSO BEING THE CENTERLINE OF MILITARY TRAIL, (S.R. NO. 809), A 100 FOOT ROAD RIGHT OF WAY, A DISTANCE OF 75.02 FEET TO THE EASTERLY PROLONGATION OF THE SOUTH RIGHT OF WAY LINE OF LAKE WORTH DRAINAGE DISTRICT LATERAL CANAL L-13, (A 75 FOOT CONCRETE CANAL OF WAY); THENCE, NORTH 88° 35' 37" WEST, ALONG SAID EASTERLY PROLONGATION AND ALONG SAID SOUTH RIGHT OF WAY LINE, PARALLEL AND DISTANT 75 FEET SOUTHERLY OF, AS MEASURED AT RIGHT ANGLES TO THE NORTH LINE OF THE SOUTHWEST ONE QUARTER OF SAID SECTION 25, A DISTANCE OF 50.07 FEET FOR A POINT OF BEGINNING, (P.O.B.);

THENCE, SOUTH 00° 02' 34" EAST, ALONG THE EXISTING WEST RIGHT OF WAY LINE OF MILITARY TRAIL, PARALLEL WITH AND DISTANT 50 FEET WESTERLY OF, AS MEASURED AT RIGHT ANGLES TO, THE EAST LINE OF THE SOUTHWEST ONE QUARTER OF SAID SECTION 25, A DISTANCE OF 596.91 FEET TO THE SOUTH LINE OF THE NORTH ONE HALF OF THE NORTHEAST ONE QUARTER OF THE SOUTHWEST ONE QUARTER OF SAID SECTION 25;

THENCE, NORTH 88° 32' 25" WEST, ALONG SAID SOUTH LINE, A DISTANCE OF 1284.10 FEET TO THE WEST LINE OF THE NORTH ONE HALF OF THE NORTHEAST ONE QUARTER OF THE SOUTHWEST ONE QUARTER OF SAID SECTION 25;

THENCE, NORTH 00° 06' 46" WEST, ALONG SAID WEST LINE, A DISTANCE OF 595.73 FEET TO THE SOUTH RIGHT OF WAY LINE OF SAID LAKE WORTH DRAINAGE DISTRICT LATERAL CANAL L-13;

THENCE, SOUTH 88° 35' 37" EAST, ALONG SAID SOUTH RIGHT OF WAY LINE, PARALLEL WITH AND DISTANT 75 FEET SOUTHERLY OF, AS MEASURED AT RIGHT ANGLES TO, THE NORTH LINE OF THE SOUTHWEST ONE QUARTER OF SAID SECTION 25, A DISTANCE OF 1284.79 FEET TO THE POINT OF BEGINNING (P.O.B.);

CONTAINING: 17.58 ACRES, MORE OR LESS.

HAVE CAUSED THE SAME TO BE SURVEYED AND PLATTED AS SHOWN HEREON AND DO HEREBY DEDICATE AS FOLLOWS:

- ROAD RIGHT OF WAY FOR HOLLY LAKE DRIVE AND ADDITIONAL ROAD RIGHT OF WAY FOR MILITARY TRAIL, IS HEREBY DEDICATED TO THE BOARD OF COUNTY COMMISSIONERS OF PALM BEACH COUNTY, FLORIDA, FOR THE PERPETUAL USE OF THE PUBLIC FOR PROPER PURPOSES.
- THE UTILITY EASEMENTS & DRAINAGE EASEMENTS, AS SHOWN ARE HEREBY DEDICATED IN PERPETUITY FOR THE CONSTRUCTION AND MAINTENANCE OF UTILITIES.
- THE WATER MANAGEMENT TRACT AND DRAINAGE EASEMENT, and the RECREATION TRACT, AS SHOWN ARE HEREBY DEDICATED TO "THE COUNTRY HOME OWNERS' ASSOCIATION, INC.," AND ARE THE PERPETUAL MAINTENANCE OBLIGATION OF SAID HOME OWNERS' ASSOCIATION.
- THE PARKING ACCESS AND UTILITY TRACT, MORE PARTICULARLY DESCRIBED ON SHEET 2 OF THIS DRAWING, IS HEREBY DEDICATED TO "THE COUNTRY HOME OWNERS' ASSOCIATION, INC." AND IS THE PERPETUAL MAINTENANCE OBLIGATION OF SAID HOME OWNERS' ASSOCIATION.

IN WITNESS WHEREOF, COUNTRY DEVELOPMENT CORP., A FLORIDA CORPORATION, HAS CAUSED THESE PRESENTS TO BE SIGNED BY ITS PRESIDENT, JOE O. HENRY, AND ATTESTED TO BY ITS SECRETARY, DONALD E. GREENFIELD, AND ITS CORPORATE SEAL TO BE AFFIXED HERETO, BY AND WITH THE AUTHORITY OF ITS BOARD OF DIRECTORS THIS 23 DAY OF Dec. AD 1976.

ATTEST: *Donald E. Greenfield* Secretary, Country Development Corporation  
*Joe O. Henry* President, Country Development Corporation

ACKNOWLEDGMENT

STATE OF FLORIDA  
COUNTY OF PALM BEACH

BEFORE ME PERSONALLY APPEARED JOE O. HENRY and DONALD E. GREENFIELD, known to me to be the individuals described in and who executed the foregoing instrument as president and secretary of the above named Country Development Corp., a Florida corporation, and severally acknowledged to and before me that they executed such instrument as such president and secretary, respectively, of said corporation, and that the seal affixed to the foregoing instrument is the corporate seal of said corporation, and that it was affixed to said instrument by due and regular corporate authority, and that said instrument was the free act and deed of said corporation.

WITNESS MY HAND AND OFFICIAL SEAL THIS 17 DAY OF January, AD 1976.

NOTARY PUBLIC: *Mary Susan Blanton*  
My Commission Expires 1-15-77

IN WITNESS WHEREOF, FLA MANGO, INC., A FLORIDA CORPORATION, HAS CAUSED THESE PRESENTS TO BE SIGNED BY THE PRESIDENT, HOWARD GREENFIELD AND ATTESTED BY THE SECRETARY, LENORE GREENFIELD, AND ITS CORPORATE SEAL TO BE AFFIXED BY AND WITH THE AUTHORITY OF ITS BOARD OF DIRECTORS THIS 29 DAY OF November, AD 1976.

ATTEST: *Howard Greenfield* Secretary, Fla Mango, Inc.  
*Lenore Greenfield* President, Fla Mango, Inc.

STATE OF FLORIDA  
COUNTY OF PALM BEACH

BEFORE ME PERSONALLY APPEARED HOWARD GREENFIELD and Lenore Greenfield to me well known, and known to me to be the individuals described in and who executed the foregoing instrument as president and secretary of the above named FLA MANGO, INC., A FLORIDA CORPORATION, AND SEVERALLY ACKNOWLEDGED TO AND BEFORE ME THAT THEY EXECUTED SUCH INSTRUMENT AS SUCH PRESIDENT AND SECRETARY, RESPECTIVELY, OF SAID CORPORATION, AND THAT THE SEAL AFFIXED TO THE FOREGOING INSTRUMENT IS THE CORPORATE SEAL OF SAID CORPORATION, AND THAT IT WAS AFFIXED TO SAID INSTRUMENT BY DUE AND REGULAR CORPORATE AUTHORITY, AND THAT SAID INSTRUMENT IS THE FREE ACT AND DEED OF SAID CORPORATION.

WITNESS MY HAND AND OFFICIAL SEAL THIS 29 DAY OF November, AD 1976.

NOTARY PUBLIC: *Alma Wein*  
My Commission Expires Oct. 24 1980

THE COUNTRY

BEING A PORTION OF THE NORTH 1/2 OF THE NORTHEAST 1/4 OF THE SOUTHWEST 1/4 OF SECTION 25, TOWNSHIP 44 SOUTH, RANGE 42 EAST, PALM BEACH COUNTY, FLORIDA

SEPTEMBER, 1976

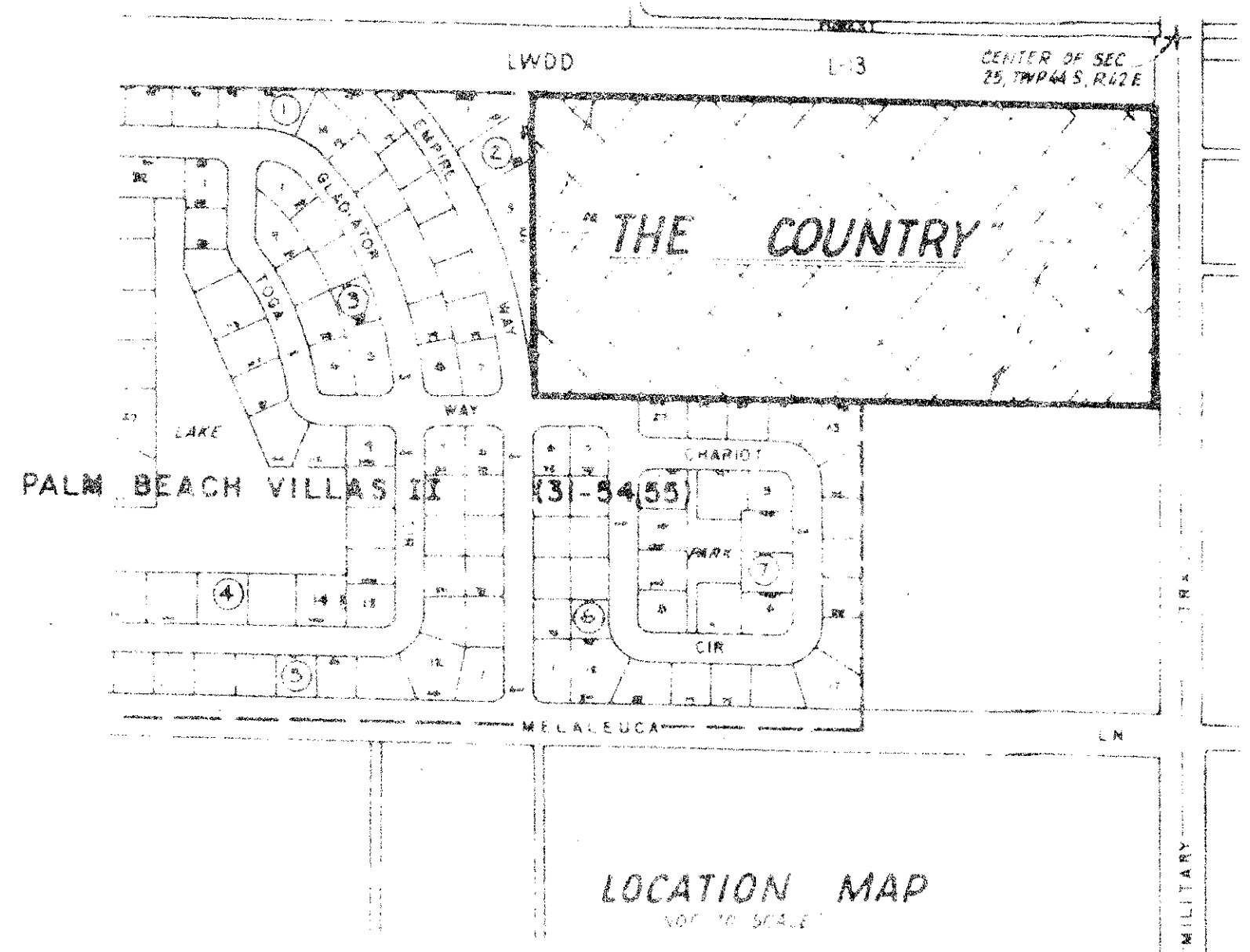

MORTGAGE CONSENT

STATE OF FLORIDA  
COUNTY OF PALM BEACH

THE UNDERSIGNED ASSOCIATION, HEREBY CERTIFIES THAT IT IS THE HOLDER OF A MORTGAGE UPON THE HEREIN DESCRIBED PROPERTY & DOES HEREBY JOIN IN AND CONSENT TO THE DEDICATION OF THE LANDS DESCRIBED IN THE DEDICATION HEREON, BY THE OWNER THEREOF, AND AGREES THAT ITS MORTGAGE WHICH IS RECORDED IN OFFICIAL RECORD BOOK 2609, PAGE 1356 OF THE PUBLIC RECORDS OF PALM BEACH COUNTY, FLORIDA, SHALL BE SUBORDINATED TO THE DEDICATION SHOWN HEREON.

IN WITNESS THEREOF THE UNDERSIGNED ASSOCIATION, HAS CAUSED THESE PRESENTS TO BE SIGNED BY ITS PRESIDENT, H. ELMO ROBINSON & ATTESTED TO BY ITS SECRETARY, CHARLES R. LEE, & ITS OFFICIAL SEAL TO BE AFFIXED HERETO, BY & WITH THE AUTHORITY OF ITS BOARD OF DIRECTORS THIS DAY OF AD 1976.

FIRST FEDERAL SAVINGS & LOAN ASSOCIATION OF THE PALM BEACHS  
ATTEST: SECRETARY--CHARLES R. LEE PRESIDENT--H. ELMO ROBINSON

189

STATE OF FLORIDA  
COUNTY OF PALM BEACH

This plat was filed for record on the 23 day of December, AD 1976, and duly recorded in Plat Book 31, Page 189.

JOHN B. DUNKLE, Clerk  
Clerk of Court

APPROVAL: PALM BEACH COUNTY, FLORIDA BOARD OF COUNTY COMMISSIONERS

THIS PLAT IS HEREBY APPROVED FOR RECORD THIS 23 DAY OF Dec. AD 1976.

COUNTY ENGINEER: HERBERT T. JAMES, JR., P.E.

THIS PLAT IS HEREBY FOUND TO BE IN ACCORD WITH THE REQUIREMENTS OF THE STATE AND LOCAL ORDINANCES.

ATTEST: JOHN B. DUNKLE, Clerk BOARD OF COUNTY COMMISSIONERS

SURVEYOR'S NOTES:

- BUILDING SET BACK LINES SHALL BE AS REQUIRED BY THE CURRENT PALM BEACH COUNTY ZONING REGULATIONS.
- ALL PERMANENT REFERENCE MONUMENTS, POINTS ARE DESTROYED THUS: (2424) (229)
- ALL PERMANENT CONTROL POINTS, POINTS ARE DESTROYED THUS: (2424) (229)
- THERE SHALL BE NO CONSTRUCTION OR BUILDINGS OR TREES OR SHRUBS PLACED ON THE PLAT.
- ALL BEARINGS STATED HEREON AND AS SHOWN HEREON, ARE BASED ON THE BEARINGS AS SHOWN ON THE PLAT OF PALM BEACH COUNTY, FLORIDA, ACCORDING TO THE PLAT THEREOF, AS RECORDED IN PLAT BOOK 31, PAGES 54 THRU 59, THE PUBLIC RECORDS OF PALM BEACH COUNTY, FLORIDA.

DATE: 10th DAY OF DECEMBER, 1976. BY: *Wayne D. Cameron*  
Notary Public, State of Florida

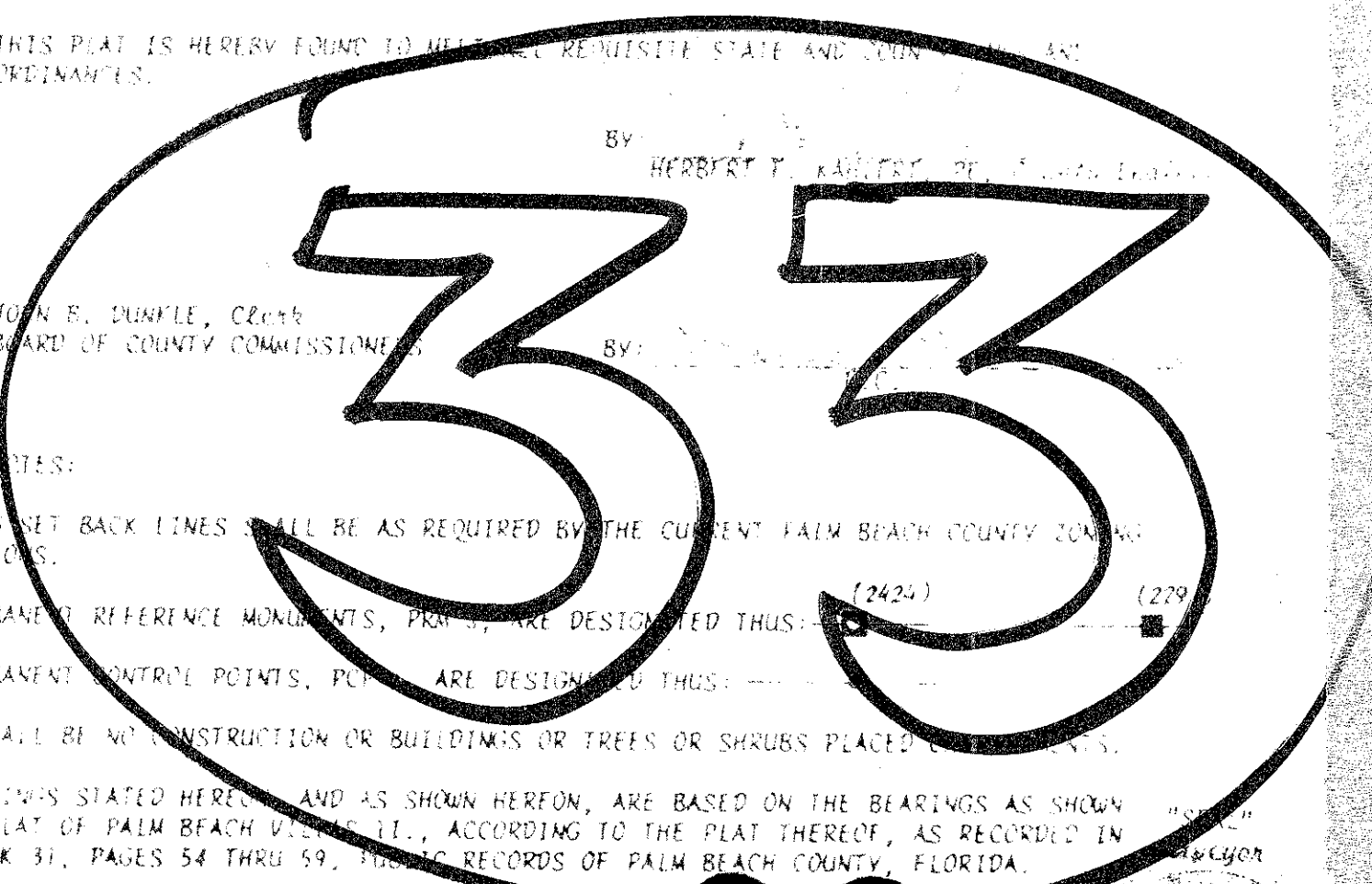

1000-164

25/44/142

THIS INSTRUMENT WAS PREPARED BY ROBERT J. WHIDDEN IN THE OFFICE OF WANTMAN & ASSOCIATES, INC., 2400 PALM BEACH LAKES BOULEVARD, WEST PALM BEACH, FLORIDA, 33409.

WANTMAN & ASSOCIATES, INC.  
CONSULTING ENGINEERS  
WEST PALM BEACH, FLORIDA

"THE COUNTRY"

NO.	DATE	DESCRIPTION	DRAWN BY/MAN	FIELD BOOK NO.	PG.	DATE	JOB NO.	SHEET
						9/76	2205	1 of 2

"SEAL" NOTARY

"SEAL" C.D. CORP.

"SEAL" Fla. Mango Inc.

"SEAL" Notary

"SEAL" Janussek Notary

"SEAL" H. F. Kohlent

"SEAL" Deputy Clerk

THE COUNTRY